

	FRAME	MASONRY
LIVING	2000 SQUARE FEET	2061 SQUARE FEET
GARAGE AND STORAGE	662 SQUARE FEET	688 SQUARE FEET
PORCH	497 SQUARE FEET	497 SQUARE FEET
TOTAL UNDER ROOF	3159 SQUARE FEET	3246 SQUARE FEET

Ridgeway Homes  
John W. Ridgeway Contractors, LLC

PLAN NO. 21326

WIDTH: 68'-10"

DEPTH: 74'-4"

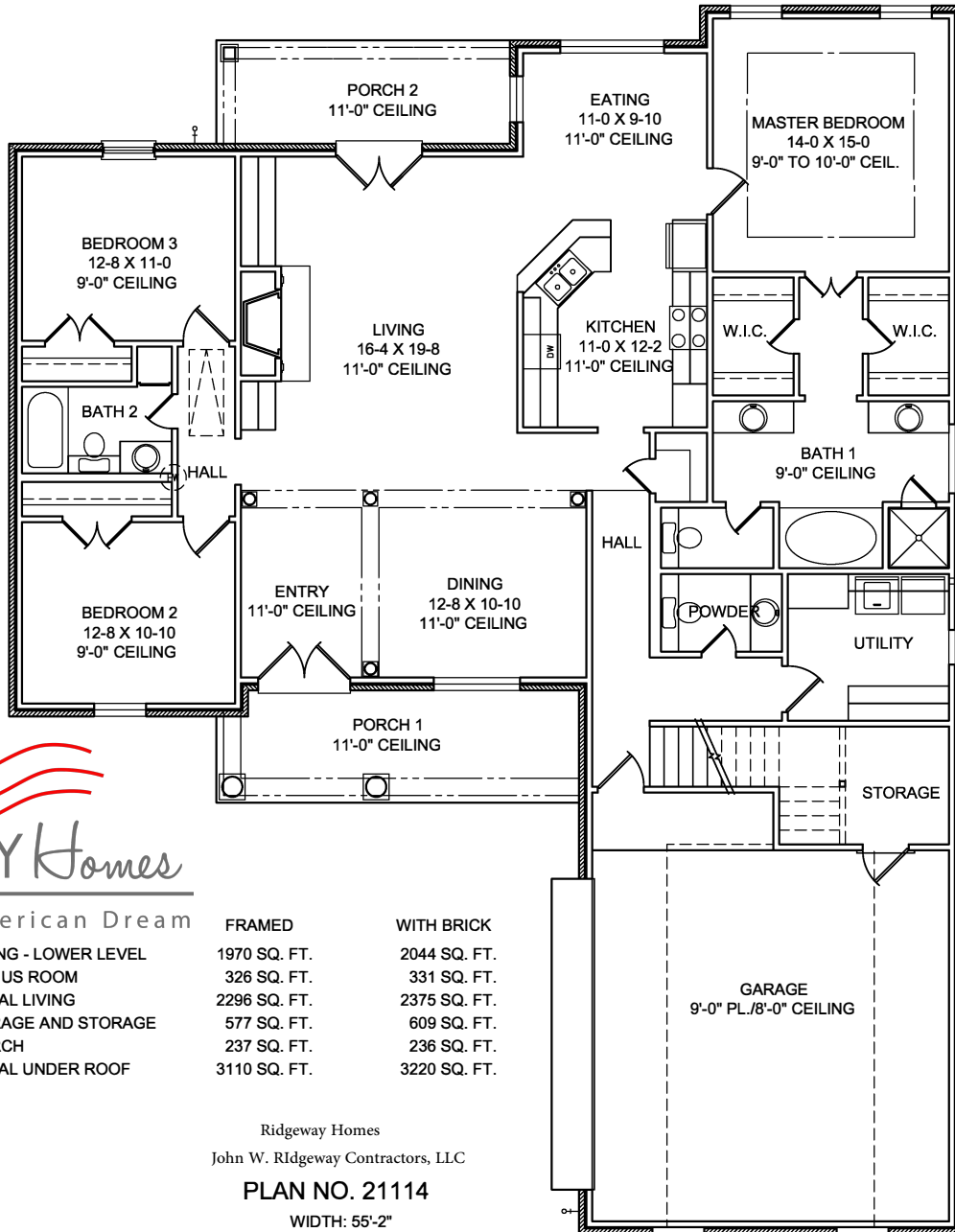

	FRAMED	WITH BRICK
LIVING - LOWER LEVEL	1970 SQ. FT.	2044 SQ. FT.
BONUS ROOM	326 SQ. FT.	331 SQ. FT.
TOTAL LIVING	2296 SQ. FT.	2375 SQ. FT.
GARAGE AND STORAGE	577 SQ. FT.	609 SQ. FT.
PORCH	237 SQ. FT.	236 SQ. FT.
TOTAL UNDER ROOF	3110 SQ. FT.	3220 SQ. FT.

Ridgeway Homes  
 John W. Ridgeway Contractors, LLC

**PLAN NO. 21114**

WIDTH: 55'-2"  
 DEPTH: 71'-2"